

To adjust the soft close start from 30° to 10°, move the switch to **0**.

To adjust the soft close start from 10° to 30°, move the switch to **I**.

ATTENTION

DO NOT insert with a hammer or mallet.

DO NOT remove the soft-close mechanism as it will cause permanent damage.

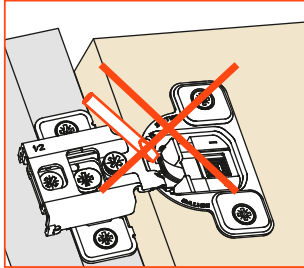
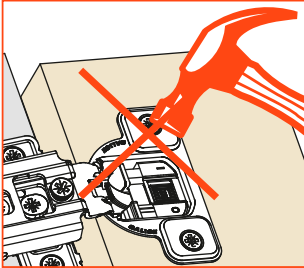

General information

All overlays are calculated with a K = 2.5 mm.

All Silentia face frame hinges have an variable drilling distance (K) of 2.5 mm - 6.0 mm.

Boring Pattern

Boring distance from the edge of the door:

Press-in

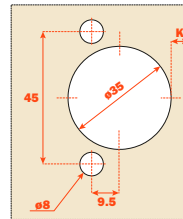

Screw-in.

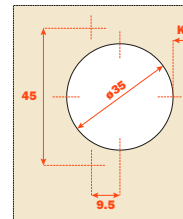

Recommended number of hinges per door.

Door width up to 24" - 610 mm

The number of hinges required depends on the size, weight and quality of the door. The distance between the top and bottom hinge must be greater than the width of the door. Additional hinges should be added if doors are near the border line of size or weight chart. Use the diagram below to determine number of hinges needed.

| Maximum door weight. | | | |
|----------------------|------|------|------|
| Ø 35 mm | 20lb | 40lb | 60lb |
| No. of hinges | 2 | 3 | 4 |

Door Height

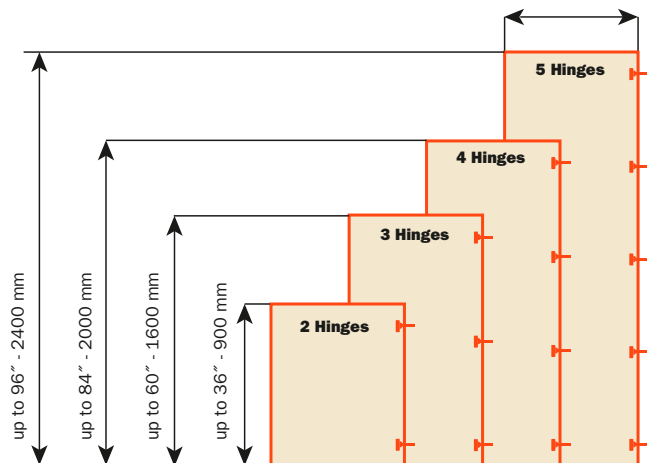

Millimeter to inch equivalents

| | | | | | | | | | | | | | | | | |
|------|-------|--------|-------|--------|--------|--------|-------|--------|--------|--------|--------|--------|--------|--------|--------|------|
| mm | 1 | 1.5 | 2 | 3 | 4 | 5 | 5.5 | 6 | 7 | 8 | 9 | 9.5 | 10 | 11 | 12 | 13 |
| inch | 1/32" | 1/16" | 3/32" | 1/8" | 5/32" | 3/16" | 7/32" | 1/4" | 9/32" | 5/16" | 11/32" | 3/8" | 13/32" | 7/16" | 15/32" | 1/2" |
| mm | 14 | 15 | 16 | 17 | 17.5 | 18 | 19 | 20 | 20.5 | 21 | 22 | 23 | 24 | 24.5 | 25.4 | |
| inch | 9/16" | 19/32" | 5/8" | 21/32" | 11/16" | 23/32" | 3/4" | 25/32" | 13/16" | 27/32" | 7/8" | 29/32" | 15/16" | 31/32" | 1" | |

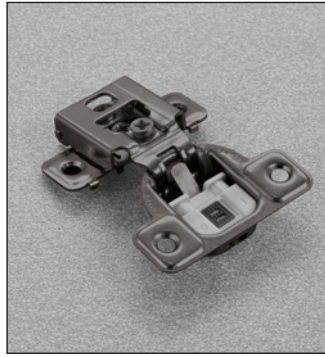
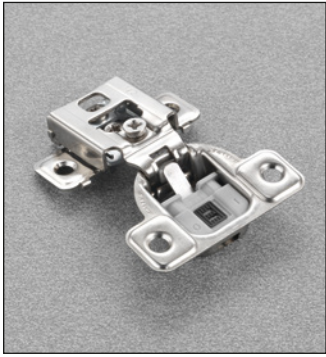

Integrated soft close face frame hinge with adjustment switch.

Stamped steel
 Minimum door thickness 14mm (9/16")
 Maximum door thickness 22mm (7/8")
 Cup depth 11mm (7/16")
 Opening 106°

Edgемount (front tabs only)

All Silentia face frame hinges have a variable drilling distance (K) of 2.5 mm - 6.0 mm.

Available in Nickel or Titanium finish

| | 106° ø35 | 106° ø35 | 106° ø35 | 106° ø35 | Packaging |
|--|----------------------|----------------------|----------------------|----------------------|-----------|
| | | | | | |
| | 1/2" | 9/16" | 5/8" | 3/4" | |
| | CUP37D9R | CUP36D9R | CUP35D9R | CUP34D9R | 300 |
| | CUP37D6R Titanium | CUP36D6R Titanium | CUP35D6R Titanium | CUP34D6R Titanium | 300 |
| | CUR37D9R | CUR36D9R | CUR35D9R | CUR34D9R | 300 |
| | CUR37D6R Titanium | CUR36D6R Titanium | CUR35D6R Titanium | CUR34D6R Titanium | 300 |
| All overlays are calculated with a K = 2.5 mm. | | | | | |
| | | | | | |
| | | | | Zero-door protrusion | |
| #6 x 5/8" flat head wood screw - VU73X154 Nickel - V234X166 Titanium | | | | | |

Ideal for refacing and other applications where frame thickness varies. Hinge is indexed from the front of the face frame only. There is no back tab.

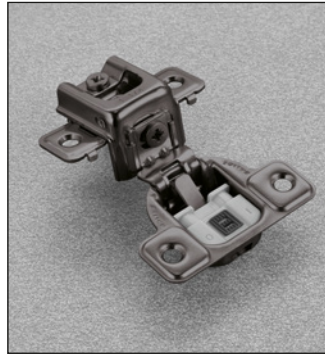
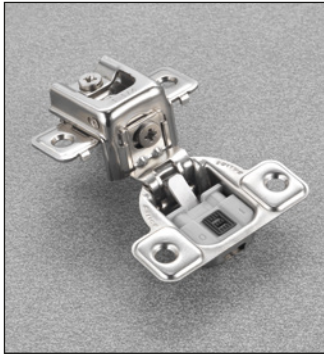

Integrated soft close face frame hinge with adjustment switch.

Stamped steel
 Minimum door thickness 14mm (9/16")
 Maximum door thickness 22mm (7/8")
 Cup depth 11mm (7/16")
 Opening 106°

Edgemount (front tabs only)

All Silentia face frame hinges have a variable drilling distance (K) of 2.5 mm - 6.0 mm.

Available in Nickel or Titanium finish

| | 106° ø35 | 106° ø35 | 106° ø35 | 106° ø35 | Packaging |
|---|----------------------|----------------------|----------------------|----------------------|-----------|
| | | | | | |
| | 11 (7/16") | 11 (7/16") | 11 (7/16") | 11 (7/16") | |
| | 1" | 1 - 1/4" | 1 - 5/16" | 1 - 3/8" | |
| | CUP32D9R | CUP3AD9R | CUP3BD9R | CUP3CD9R | 300 |
| | CUP32D6R Titanium | CUP3AD6R Titanium | CUP3BD6R Titanium | CUP3CD6R Titanium | 300 |
| | CUR32D9R | CUR3AD9R | CUR3BD9R | CUR3CD9R | 300 |
| | CUR32D6R Titanium | CUR3AD6R Titanium | CUR3BD6R Titanium | CUR3CD6R Titanium | 300 |
| All overlays are calculated with a K = 2.5 mm. | | | | | |
| | | | | | |
| Zero-door protrusion on all overlays - #6 x 5/8" flat head wood screw - VU73X154 Nickel - V234X166 Titanium | | | | | |

| | 106° ø35 | 106° ø35 | | | Packaging |
|---|----------------------|----------------------|--|--|-----------|
| | | | | | |
| | 11 (7/16") | 11 (7/16") | | | |
| | 1 - 7/16" | 1 - 9/16" | | | |
| | CUP3DD9R | CUP3ED9R | | | 300 |
| | CUP3DD6R Titanium | CUP3ED6R Titanium | | | 300 |
| | CUR3DD9R | CUR3ED9R | | | 300 |
| | CUR3DD6R Titanium | CUR3ED6R Titanium | | | 300 |
| All overlays are calculated with a K = 2.5 mm. | | | | | |
| | | | | | |
| Zero-door protrusion on all overlays - #6 x 5/8" flat head wood screw - VU73X154 Nickel - V234X166 Titanium | | | | | |

Ideal for refacing and other applications where frame thickness varies. Hinge is indexed from the front of the face frame only. There is no back tab.

Zero-door protrusion from 3/4" to 1 - 3/8" overlay.
Edgemoount (front tabs only)

Partial overlay

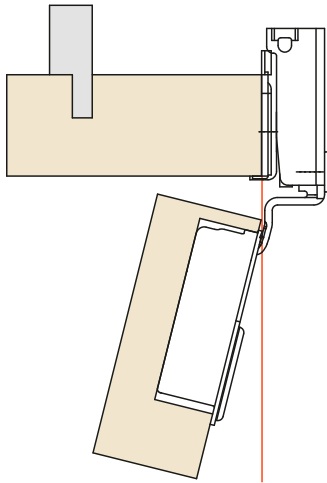

Full overlay

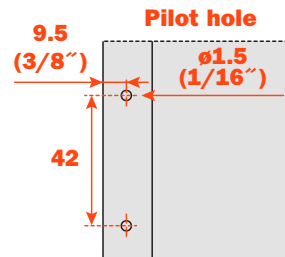
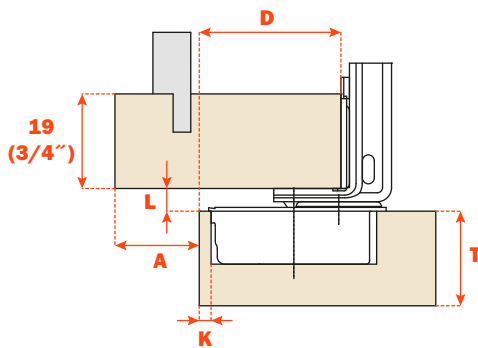
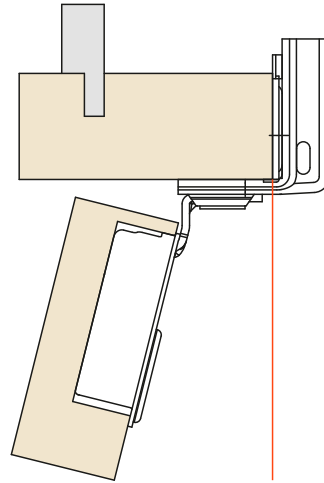

Suggested frame fixing screw #6 x 5/8"
VU73X154 Nickel - V234X166 Titanium

- D** = required door overlay
- T** = max. door thickness
- K** = drilling distance
- A** = reveal
- L** = gap between door and frame

- T= Maximum 22mm (7/8") max

All overlays are calculated with a K = 2.5 mm.

All Silentia face frame hinges have a variable drilling distance (K) of 2.5 mm - 6.0 mm.

- L = 4.6 mm

- "A" value = 5.6 mm min. (7/32") for 19mm (3/4") square edge doors.

Height adjustment by eccentric cam = **+/- 1.85 mm (3/32")**

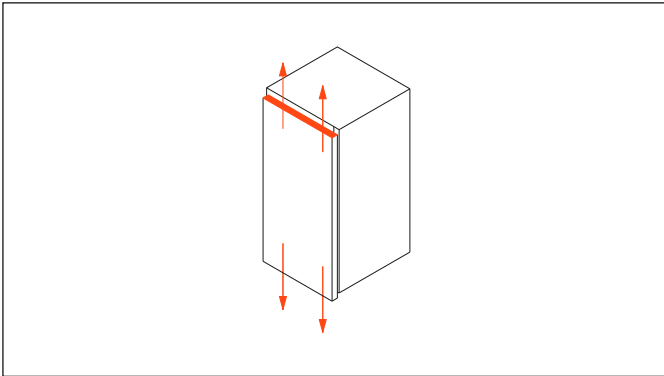

Side adjustment by eccentric cam for hinges: CU_37D_R - CU_34D_R = **+2.5mm (3/32") / -1.8mm (1/16")**
CU_32D_R - CU_3AD_R - CU_3CD_R = **+3mm (1/8") / -2mm (3/32")**

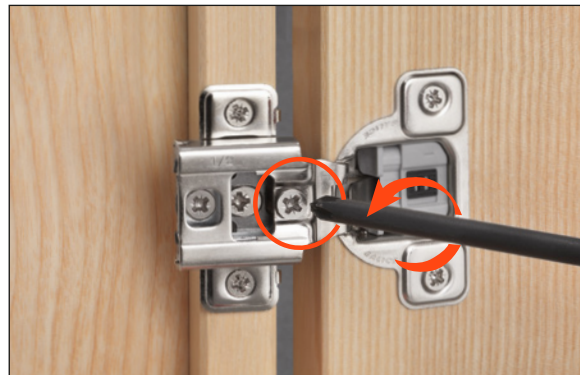
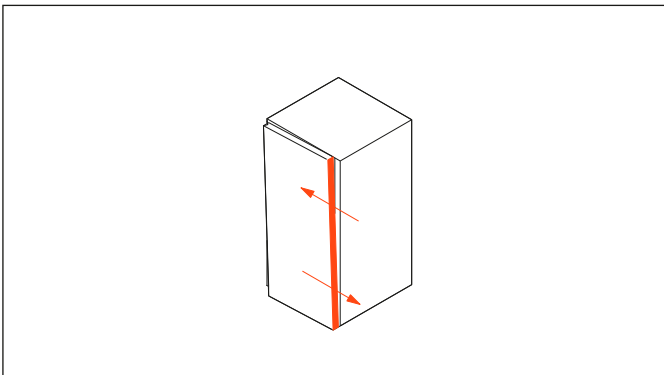

Depth adjustment by eccentric cam: **+ 2.5 mm (+ 3/32) / - 0.5 mm (- 1/64")**

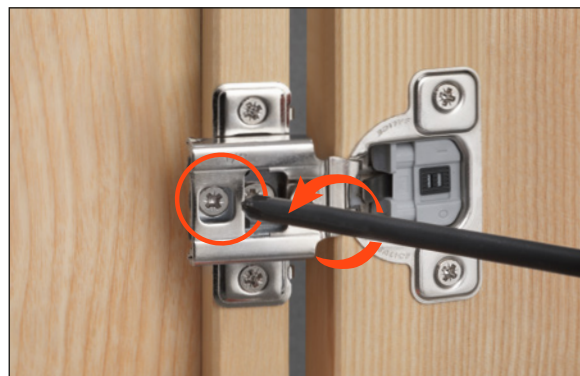
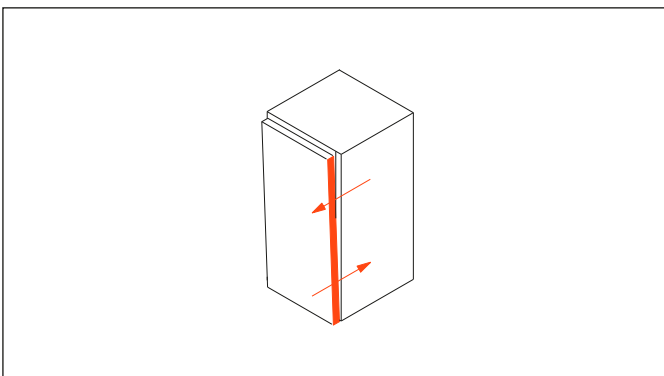

use a #2 Pozi driver on all screws. See page #15.